

Bellefield

Slough • • SL1 5FP
Guide Price: £400,000



coopers
est 1986

Bellefield

Slough • • SL1 5FP

A modern two bedroom terraced home situated on Bellefield, within a highly sought after development, conveniently located within a mile of schools and excellent transport links. The ground floor comprises a spacious kitchen with integrated appliances, living/dining room which opens onto the patio through French doors and a convenient downstairs cloakroom. Upstairs, there is two generously sized bedrooms, both with built in storage and en-suites. Outside, there is an allocated parking space and a private rear garden.

No chain

Sought after development

Modern throughout

Spacious living & dining room

Constructed 2012

En-suites to both bedrooms

Allocated parking

1.1 Mile Away From Elizabeth Line

Good schools within catchment

Local amenities close by

These particulars are intended as a guide and must not be relied upon as statements of fact. Your attention is drawn to the Important Notice on the last page.





Bellefield, Slough, SL1

Approximate Area = 715 sq ft / 66.4 sq m

For identification only - Not to scale

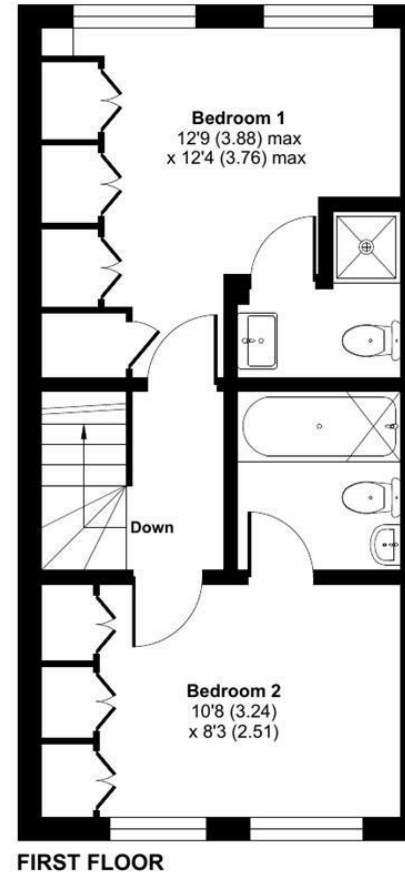

Floor plan produced in accordance with RICS Property Measurement 2nd Edition, Incorporating International Property Measurement Standards (IPMS2 Residential). © n/checom 2025. Produced for Coopers. REF: 1263823

coopers
est 1986

coopers
est 1986

42 Queen Street, Maidenhead,
SL6 1HZ

CoopersResidential.co.uk

| Energy Efficiency Rating | | Current | Target |
|--|---|-------------------------|--------|
| Very energy efficient - lower running costs | A | | |
| Energy efficient - lower running costs | B | | |
| Decent energy efficiency - lower running costs | C | 83 | 84 |
| Some energy efficiency - lower running costs | D | | |
| Not very energy efficient - higher running costs | E | | |
| Very poor energy efficiency - higher running costs | F | | |
| Energy inefficient - higher running costs | G | | |
| England & Wales | | EG Effective 2022/01/01 | |

Important Notice: These particulars, whilst believed to be accurate are set out as a general outline only for guidance and do not constitute any part of an offer or contract. Intending purchasers should not rely on them as statements or representation of fact, but must satisfy themselves by inspection or otherwise has the authority to make or give any representation or warranty in respect of the property.